



MODEL YAMAHA MT-03 660

YEAR 2006-->

LINE SPORT

MUFFLER GP

SCHEMATIC

ELENCO PARTI / PARTS LIST

| # | QTÀ / QTY | DESCRIZIONE / DESCRIPTION | CODICE / CODE |
|----|-----------|--|---------------|
| 1 | 2 | DB killer / DB killer | 50.DK.021.0 |
| 2 | 2 | Silenziatore / Muffler | GP |
| 3 | 2 | Dado M6 / Nut M6 | 50.73.146.1 |
| 4 | 4 | Rondella M6 / Washer M6 | 50.72.027.1 |
| 5 | 2 | Vite M6 x 12 / Screw M6 x 12 | 50.72.024.1 |
| 6 | 2 | Protezione in gomma / Rubber protection | 50.73.040.1 |
| 7 | 2 | Staffa / Bracket | 50.SS.001.0 |
| 8 | 4 | Dado M8 flangiato / Flanged nut M8 | 50.73.393.1 |
| 9 | 2 | Rondella in alluminio / Aluminium washer | 50.73.063.1 |
| 10 | 2 | Vite M8x25 / Screw M8x25 | 50.73.064.1 |
| 11 | 2 | Vite M8x40 / Screw M8x40 | 50.73.075.1 |
| 12 | 2 | Molla corta / Short Spring | 50.73.123.1 |
| 13 | 2 | Tubo in gomma per molla / Rubber pipe for spring | 50.73.210.1 |
| 14 | 1 | Tubo di raccordo / Link pipe | 9773UY025S2 |
| 15 | 1 | Fascetta Ø 52/55 mm / Pipe clamp Ø 52/55 mm | 50.FA.008.1 |
| 16 | 1 | Staffa / Bracket | 50.SS.157.1 |
| 17 | 1 | Staffa / Bracket | 50.SS.156.1 |

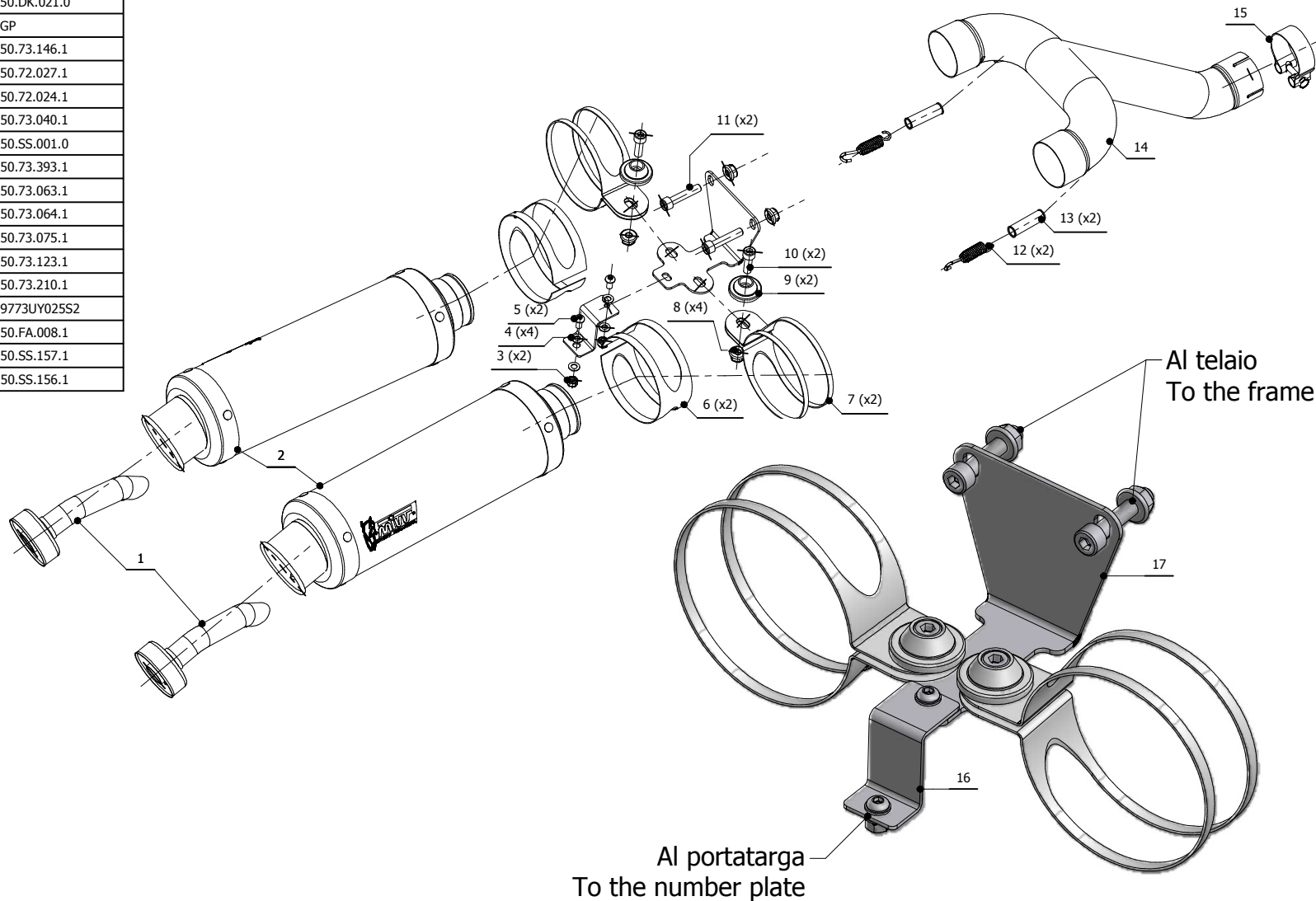

APPLICAZIONI / APPLICATIONS

| CODICE / CODE | TUBO / PIPE | SILENZIATORE / MUFFLER | FASCETTA / CLAMP |
|---------------|------------------|-------------------------|------------------|
| UY.025.L2S | INOX / ST. STEEL | CARBONIO / CARBON FIBER | INOX / ST. STEEL |
| UY.025.L6S | INOX / ST. STEEL | TITANIO / TITANIUM | INOX / ST. STEEL |
| UY.025.LXB | INOX / ST. STEEL | STEEL BLACK | INOX / ST. STEEL |